

STEP BY STEP GUIDE

STEP 1: Connect a of vertical pole with junction bar (B) together with vertical pole (B) to form a long upright pole. Repeat with the remaining set to form a second long upright pole.

STEP 2: Using a T-Clip (C), connect each upright poles to a leg (A). Note the placement mark on each leg. T-Clips should be positionned onto the marks, then well tightened.

STEP 3: With the unit facing you, position a Left T-Clip with one spring (D) towards the far bottom of the upright pole.

Note: the spring of the Left T-Clip should be facing up, while its plastic nut should be facing back. Insert a horizontal tube (F) into the Left T-Clip. Tighten the T-Clip.

STEP 4: Repeat on the other side, by positioning a Right T-Clip with one spring (E) towards the far bottom of the right upright pole. Connect that T-Clip with the other end of the horizontal tube, then tighten it.

STEP 5: Pick the remaining horizontal tube with pre-installed corners. Connect it to the top of the unit, by simply inserting the corners into the tubes.

POSTER INSTALLATION

Before inserting a poster, first open the mobile flap on each of the four poster clips, as shown to the right.

IMPORTANT: The flaps must be open to a full 90°, in order to allow enough space for the poster insertion.

Starting with corner #1 at the top of the unit, fully insert a first poster corner into a poster clip.

Secure poster corner #1 in place by pushing down all the way onto the flap.

If your banner is tear-resistant, now, repeat and proceed with the corner beside it (#2), as illustrated to the right.

You may now attach both remaining corners, in no particular order.

NOTE: If, on the other hand, your poster is thin, fragile or tearable (photo paper, etc.), the suggested order is then: #1; #4; followed by the two remaining corners. This will minimize the tension exerted on the poster.



INSTALLATION



INSTRUCTIONS

FLEX FLOOR STAND WITH T-LEGS



FLEX FLOOR STAND WITH T-LEGS

OVERVIEW

FRONT VIEW

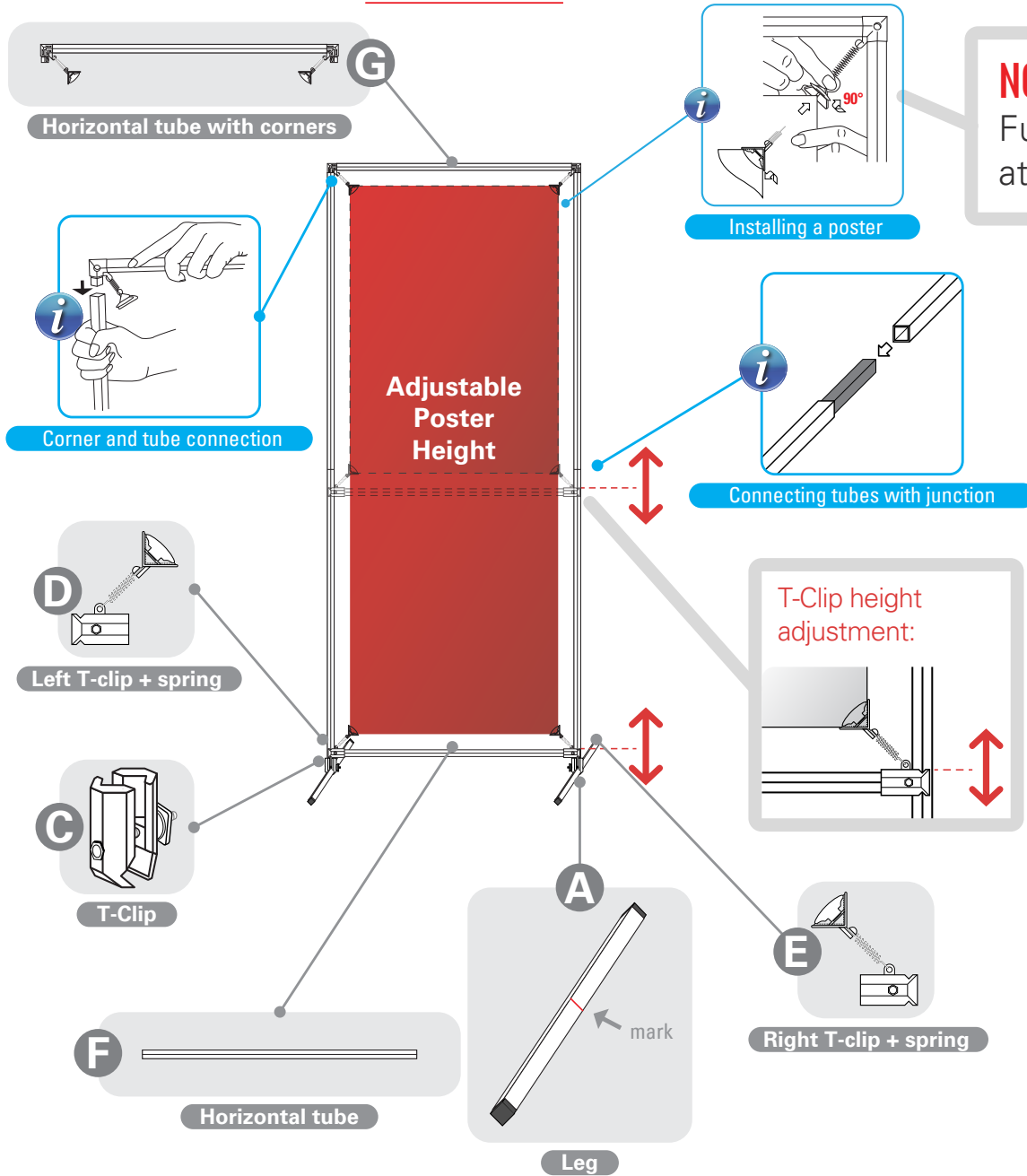

SIDE VIEW

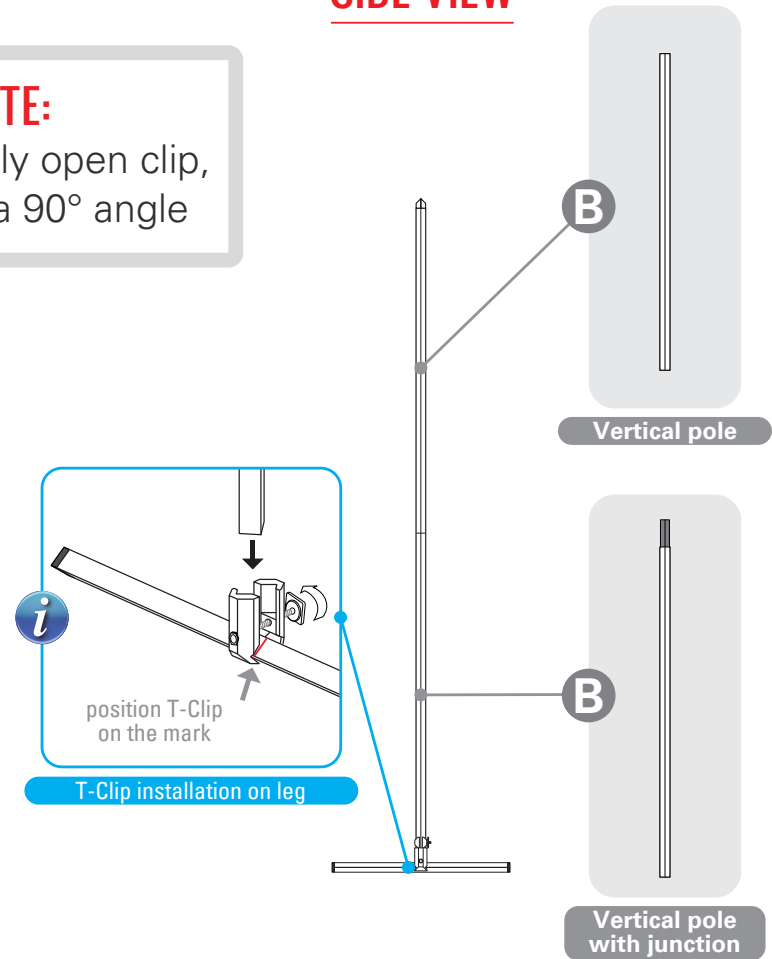

CONTENT

- A** Leg: **x2**
- B** Vertical pole: **x4**
- C** T-Clip with no springs: **x2**
- D** Left T-Clip with one spring: **x1**
- E** Right T-Clip with one spring: **x1**
- F** Horizontal tube: **x1**
- G** Horizontal tube with pre-installed corners: **x1**