

1

3

INSTALLING A POSTER

- A** Attach the first corner.
- B** Attach the opposite corner.
- C** Attach the two remaining corners.

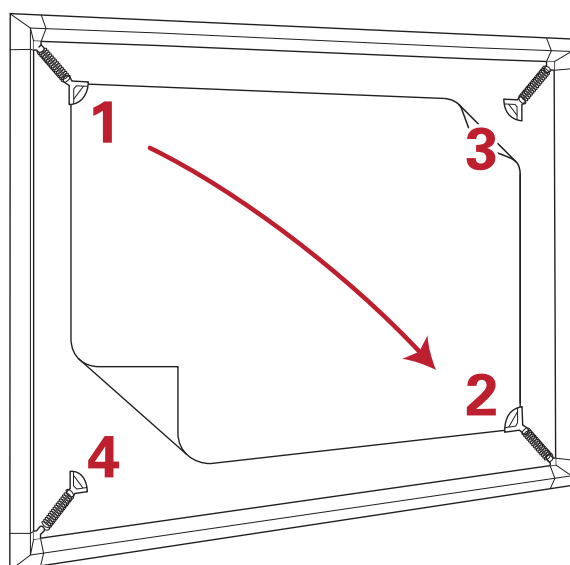

USING POSTER CLIPS

- A** Lift the poster clip to a **full 90° position**.
- B** Slide the poster corner into the clip.
- C** Push the clip down to secure the poster.

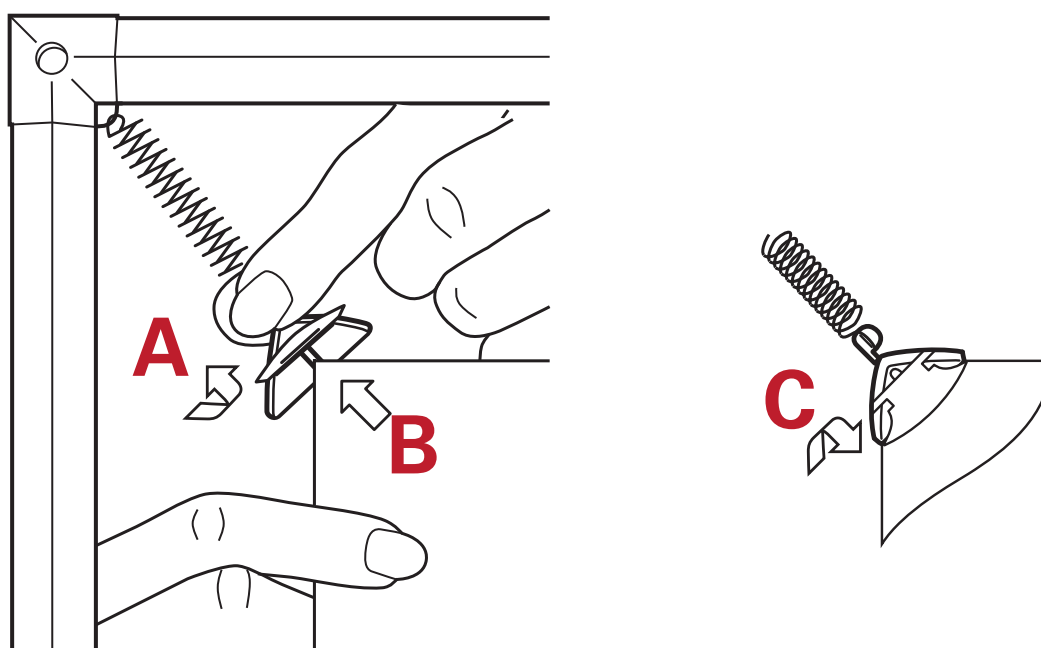

4

2